

ENHANCEMENTS

Liquid & Powder Enhancements Sculpted on a Tip



90 MIN A service designed for problem nails with no free edge, requiring length and re-design.

STEP 1:

P.R.E.P.

1. P - Perform a manicure.

- Have the client wash their hands with soap and water and towel dry.
- Massage **CoolBlue™** into the client's hands to sanitize.
- Remove existing nail color using an acetone-based polish remover (or **ScrubFresh™**) and a plastic-backed lint-free pad.
- If necessary, trim the length from each nail, using nail clippers.



- Shape the free edge of each nail with the 240-grit side of a **Kanga™ File** or **Koala Buffer™**.



- Apply a small amount of **CuticleAway** evenly around the cuticle of each nail.



Gently slide a **cuticle pusher** along the nail plate toward the cuticle area and along the lateral fold to lift and loosen any non-living tissue from the nail plate. Use a **curette** to remove non-living tissue up to the eponychium and lateral edge.

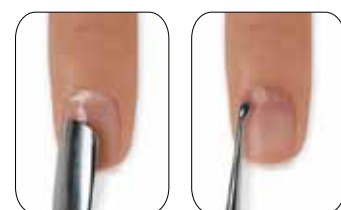

- Use a **manicure nipper** to carefully remove any loosened, non-living tissue, as well as any loose pieces of skin or hang nails. Use a gentle touch during cuticle removal to protect the seals.



- Scrub** nails thoroughly with soap and a damp brush, then rinse with warm water to remove the cuticle remover and soap; towel dry.

- ### 2. R - Remove shine from the nail surface with the 240-grit side of the **Koala Buffer** in the direction of nail growth.



3. E - Eliminate surface contaminants and **P - Purify** nail plate layers.

- a. Thoroughly cleanse and temporarily dehydrate the nail plate layers with **ScrubFresh™** using a lint-free, plastic-backed pad. Gently pull lateral folds back and scrub thoroughly to be sure all areas of the nail are completely clean.



When applying tips, it is **not necessary** to temporarily dehydrate the nail plate at this point of the service.



STEP 2:

Apply Tip

1. Fit The Tip

- a. **Match** the correct tip to the **C-curve** of the natural nail.
- b. **Fit - sidewall** - The tip should fit easily from side to side of the natural nail within the fingers' lateral sidewalls, and should encase the natural nail extension edge exactly.
- c. If necessary, **shape the natural nail extension edge** to fit the tip stop point perfectly.



2. Pre-Tailor The Tip For A Perfect Fit To The Nail

- a. The tip should fit perfectly from side to side, along the lower arch and at the back of the contact area. The contact area of the tip should cover no more than 50% of the natural nail before blended.
- b. **Pre-tailor the contact area** using a 240-grit file or cuticle scissor.



3. Apply The Tip

- a. **Place a bead of adhesive** in the contact area of the tip. Place a small line of adhesive on the natural nail plate extension edge. Hold the tip between the thumb and forefinger when applying adhesive.
- b. **Spread the adhesive** gently with the tip to completely coat the entire extension edge. Use one or two quick wiping strokes to do this. Be particularly careful to coat the corners of the natural nail and the sidewall of the contact area with adhesive.
- c. **Secure** the tip by holding it at a 45° angle and gently butt the stop point against the natural nail extension edge. Slowly lower the contact area down to the natural nail, stopping when the desired side arch is achieved, while pressing all bubbles out.
- d. **Press firmly** against the free edge for 5-10 seconds, securing the stop point to the nail.
- e. **Remove** any residual adhesive with a lint-free, plastic-backed pad.



4. Cut The Tip

- a. Use a "one-cut" implement or wide-blade curved cuticle scissors or clipper to cut the tip to desired length and shape.

5. Blend The Tip

- a. **Shape** the extension edge of the tip with a 240-grit file to create the desired shape.
- b. **Thin** the entire tip evenly using a 180-grit file in a rounded motion, paying close attention to the corners of the tip.
- c. **Bevel** Zone 1 to create a thin, even extension edge.

- d. **Refine** the entire tip with a 240-grit file to blend evenly to the nail plate. Refine any remaining tip material from the nail to prevent ghost shadowing and pocket lifting. Be sure the tip is thin, blended and translucent.



- e. **Wash** client's hands and clean the nail plate with **ScrubFresh™** after tip is thoroughly blended. Be sure to avoid the tip when cleansing the nail.

STEP 3:

Prime Nails (optional)

This step is for clients with lift-prone nails.

1. **Apply** 1 thin coat of **NailPrime** to the natural nail plate of 2-3 nails at a time ensuring that the brush has enough liquid to thoroughly and evenly cover each nail. Repeat this step until all nails are thoroughly and evenly coated.

Remember: When applying **NailPrime**, do not touch the skin or allow the product to flood the cuticle area.

STEP 4:

Zone 1 - Smile Lines

1. Place a **bead in Zone 1 near the extension edge**. Press firmly to equally wet it for easier sculpting control and to ensure the correct mix ratio.



2. Next, **press the bead up one side into the corner** to begin establishing the depth of your smile line. Use small controlled presses and a smooth, fluid motion.



3. Finish the smile line by **pressing to the opposite side** and into the corner. Smooth the entire Zone to ensure an even surface.



4. **If needed**, wipe out excess liquid from the brush. Then, using the flattened flags of the brush, detail the smile line starting from the center and working towards the corners of the smile line.

STEP 5:

Zones 2 - Apex and Upper Arch

1. Place a **bead in the middle of Zone 2**.



2. **Press product from side to side**, concentrating on making complete contact with the nail plate. Keep the **bulk of the product at the apex** and taper to the sidewalls forming a thin edge, without touching the skin. Lightly feather any remaining product to Zone 1.

3. Zone 2 should be the **thickest part of the enhancement**, protecting the stress area, where nails most often break. The highest point of the arch, called the apex, should be placed directly between the cuticle line and the extension edge for proper balance and beauty. From the apex, the product should taper to a thin edge in all directions.

STEP 6:

Zones 3 - Cuticle Area

1. Place a bead in the middle of **Zone 3** to complete the upper arch. Press from side to side until the entire area is covered, leaving a tiny free margin all the way around the sidewalls and cuticle area.



2. Check the enhancement for clean, continuous lines on both the upper and lower arch. Add product where necessary. Remember to use the highlight on the nail to look for high and low spots in the product.
3. A thin application in **Zone 3** will produce natural-looking, long-lasting enhancements, as well as help prevent lifting.

STEP 7:

Shape and Define

1. Shape and define the nail using the 180-grit side of the **Hot Shot™ File**.
2. Smooth the surface using the 240-grit side of the **Koala Buffer™**.
3. Apply a drop of **SolarOil™** into each nail and buff with the 1200-grit side of a **Koala Buffer** for scratch refinement. Rub any remaining oil into the nail and surrounding soft tissue.



STEP 8:

Bring to High Shine

1. Finish nails to a high-gloss shine with the **Girlfriend™ Buffer**, **Glossing Buffer** or **Glossing Block**.

Or, as an alternative, skip the SolarOil application above and after buffing with the **Koala Buffer**,



apply **Brisa Gloss**. Cure for two full minutes in the CND UV Lamp. Then remove sticky, uncured layer with **ScrubFresh™**.



PRODUCTS REQUIRED

Retention+™, Radical SolarNail™ or Moxie™ Sculpting Liquids
Perfect Color or Retention+ Sculpting Powders
CoolBlue™
CuticleAway
ScrubFresh
NailPrime
CND Files and Buffers
CND Tips
CND Adhesive
ProSeries Liquid & Powder Brush
Brisa Gloss*
SolarOil

ACCESSORIES/EQUIPMENT REQUIRED

Terry hand towels
Plastic-backed, lint-free pads
Polish remover
Disinfectable dust brush*
Cuticle pusher
Cuticle nippers
Nail clippers
Curette
Dappen dish
CND UV Lamp*

*Optional